

2021/22 Season Subscription Pricing

This table below displays subscription ticket prices for the 2021/22 spring season with performances occurring between February and May. Subscription tickets will go on sale to the general public on Tuesday, December 7 at noon, and presale opportunities are available for Celebrity Series members. Tickets are available now for performances occurring between October and January, and can be purchased at celebrityseries.org. Prices and sections subject to change.

PERFORMANCE	VENUE	DATE/TIME	PRICE 1	PRICE 2	PRICE 3	PRICE 4	PRICE 5	PRICE 6
Alexander Malofeev	PK	Wed. 2/2/22 8PM	\$65	\$55				
Cecile McLorin Salvant	BPC	Sat. 2/5/22 8PM	\$75	\$59	\$59	\$49	\$39	
Simone Porter	PK	Wed. 2/9/22 8PM	\$65	\$55				
Anais Mitchell + Bonny Bonny Light Horseman	BPC	Fri. 2/18/22 8PM	\$65	\$49	\$49	\$39	\$39	
A Tribute to Aretha Franklin: Damien Sneed & Karen Clark Sheard	BPC	Fri. 2/25/22 8PM	\$75	\$59	\$59	\$49	\$39	
Sankofa Danzafró	SHB	Sat. 2/26/22 8PM	\$60	\$49	\$39	\$39		
Sankofa Danzafró	SHB	Sun. 2/27/22 3PM	\$60	\$49	\$39	\$39		
Imani Winds & Catalyst Quartet	FCC	Sat. 3/5/22 8PM	\$75	\$60	\$39			
Academy of St Martin in the Fields, Joshua Bell	SH	Sun. 3/6/22 3PM	\$125	\$125	\$95	\$75	\$59	\$49
Emanuel Ax-Leonidas Kavakos- -Yo-Yo Ma	SH	Wed. 3/9/22 8PM	\$150	\$125	\$110	\$95	\$95	\$79
McGill, Phillips, Huang	GBH	Sun 3/13/22 3PM	\$75	\$55				
Brooklyn Rider & Avi Avital	GBH	Fri. 3/18/22 8PM	\$75	\$55				
Anat Cohen Quartetinho	AFH	Sat. 3/19/22 5&8PM	\$75	\$60	\$49	\$39		
Matthew Whitaker Quartet	AFH	Sun. 3/20/22 4&7PM	\$75	\$60	\$49	\$39		
Christian Sands	AFH	Fri. 3/25/22 7:30PM	\$75	\$60	\$49	\$39		
Veronica Swift	AFH	Sat. 3/26/22 5&8PM	\$75	\$60	\$49	\$39		
Regina Carter	AFH	Sun. 3/27/22 4&7PM	\$75	\$60	\$49	\$39		
The Just and the Blind	EP	Fri. 4/1/22 8PM	\$60	\$49				
The Just and the Blind	EP	Sat. 4/2/22 8PM	\$60	\$49				
Jeremy Denk	GBH	Sat. 4/2/22 8PM	\$75	\$55				
Jeremy Denk	GBH	Sun. 4/3/22 3PM	\$75	\$55				
SF Jazz Collective	BPC	Fri. 4/8/22 8PM	\$65	\$65	\$49	\$49	\$39	
Redman-Mehldau-Mcbride-Blade	SH	Sun. 4/24/22 7PM	\$75	\$59	\$59	\$49	\$39	\$29
Alvin Ailey	WT	Thu. 4/28/22 8PM	\$85	\$75	\$65	\$49		
Alvin Ailey	WT	Fri. 4/29/22 8PM	\$85	\$75	\$65	\$49		
Alvin Ailey	WT	Sat. 4/30/22 2PM	\$85	\$75	\$65	\$49		
Alvin Ailey	WT	Sat. 4/30/22 8PM	\$95	\$75	\$65	\$55		
Alvin Ailey	WT	Sun. 5/1/22 2PM	\$95	\$75	\$65	\$55		
Takacs Quartet with Julien Labro, banoneon	FCC	Sat. 4/30/22 8PM	\$75	\$60	\$39			
Sheku Kanneh-Mason	SH	Sat. 5/7/22 8PM	\$95	\$85	\$75	\$59	\$49	\$39

SH | Symphony Hall

BK | Berklee Performance Center

EP | Emerson Paramount

PK | Pickman Hall

AFH | Artists for Humanity Epicenter

GBH | GBH Colderwood Studio

FCC | First Church in Cambridge

WT | Boch Wang Theatre

SHT | Boch Shubert Theatre

Digital performance tickets are also available for select performances and are priced at \$20 per household (\$18 for Celebrity Series members).

Symphony Hall

301 Massachusetts Avenue, Boston

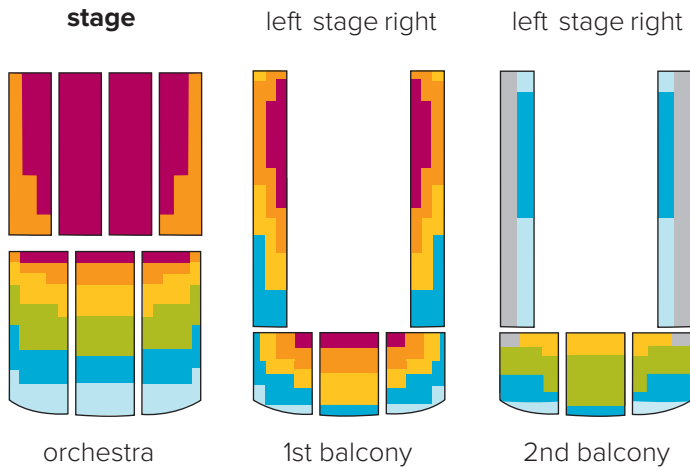

Seating sections may vary by performance.

Berklee Performance Center

136 Massachusetts Avenue, Boston

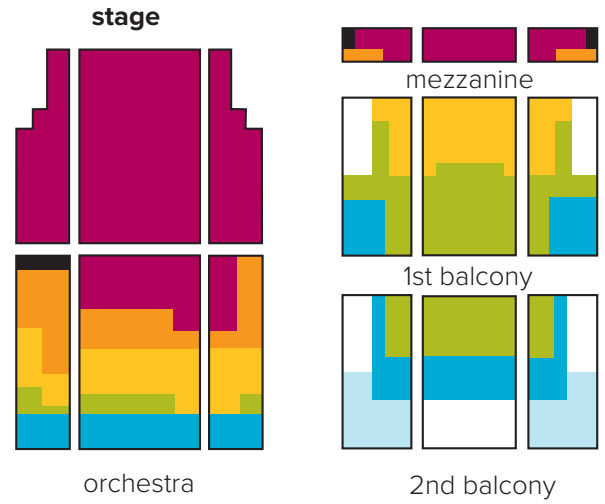

Seating sections may vary by performance.

Artists For Humanity EpiCenter

100 W 2nd St, Boston

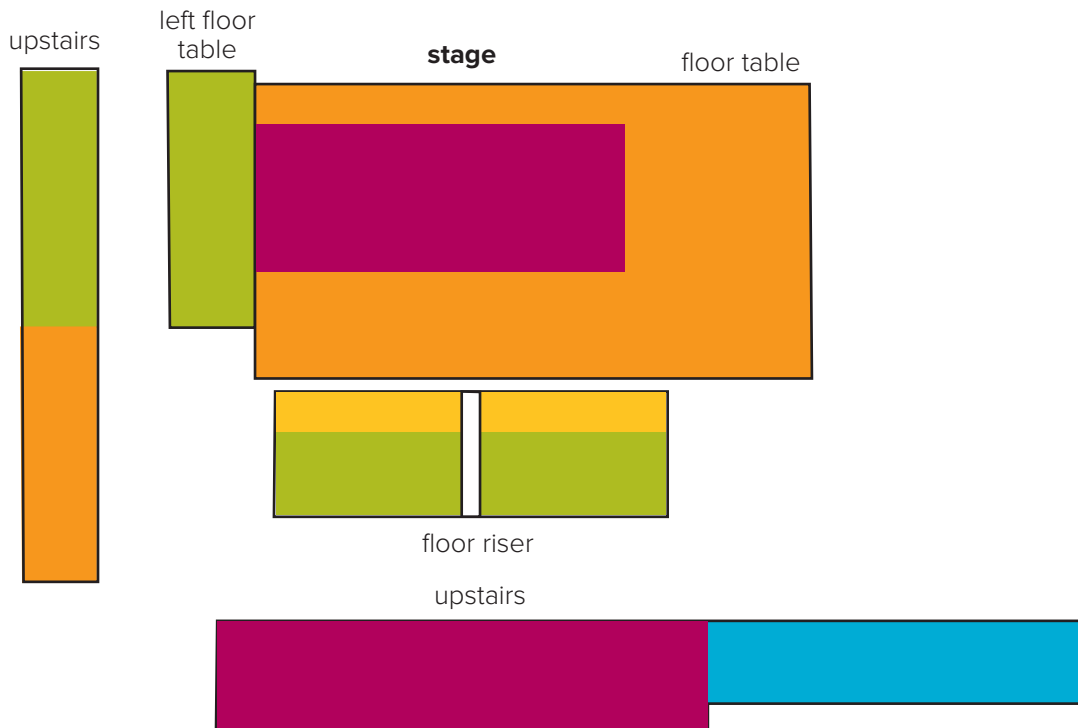

Seating sections may vary by performance.

Key



GBH Calderwood Studio

One Guest Street, Boston

stage

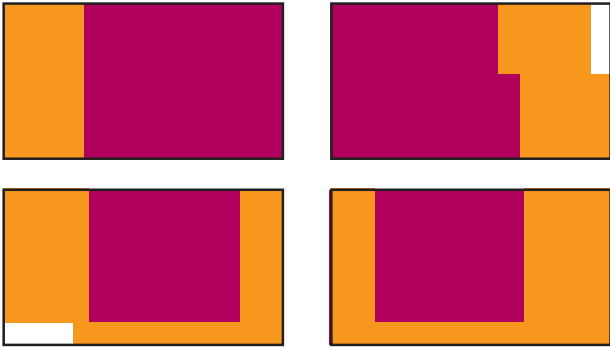

Seating sections may vary by performance.

Pickman Hall, Longy School of Music of Bard College

27 Garden Street, Cambridge

stage

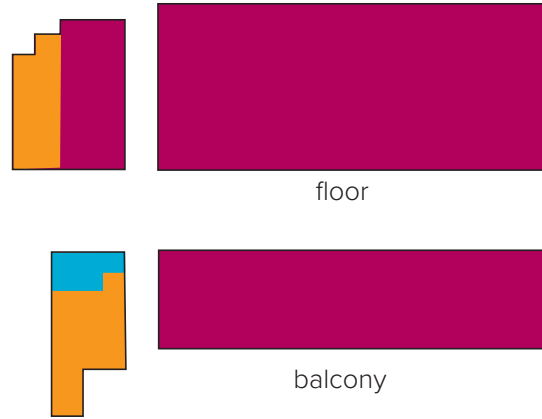

Seating sections may vary by performance.

First Church in Cambridge

11 Garden Street, Cambridge

stage

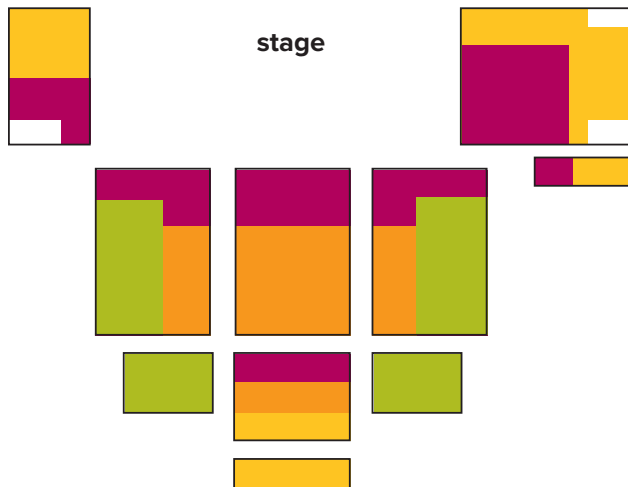

Seating sections may vary by performance.

Key

PRICE 1	PRICE 1
PRICE 2	PRICE 2
PRICE 3	PRICE 3
PRICE 4	PRICE 4
PRICE 5	PRICE 5
PRICE 6	PRICE 6
PRICE 7	PRICE 7
PRICE 8	PRICE 8

Boch Center Wang Theatre

270 Tremont Street, Boston

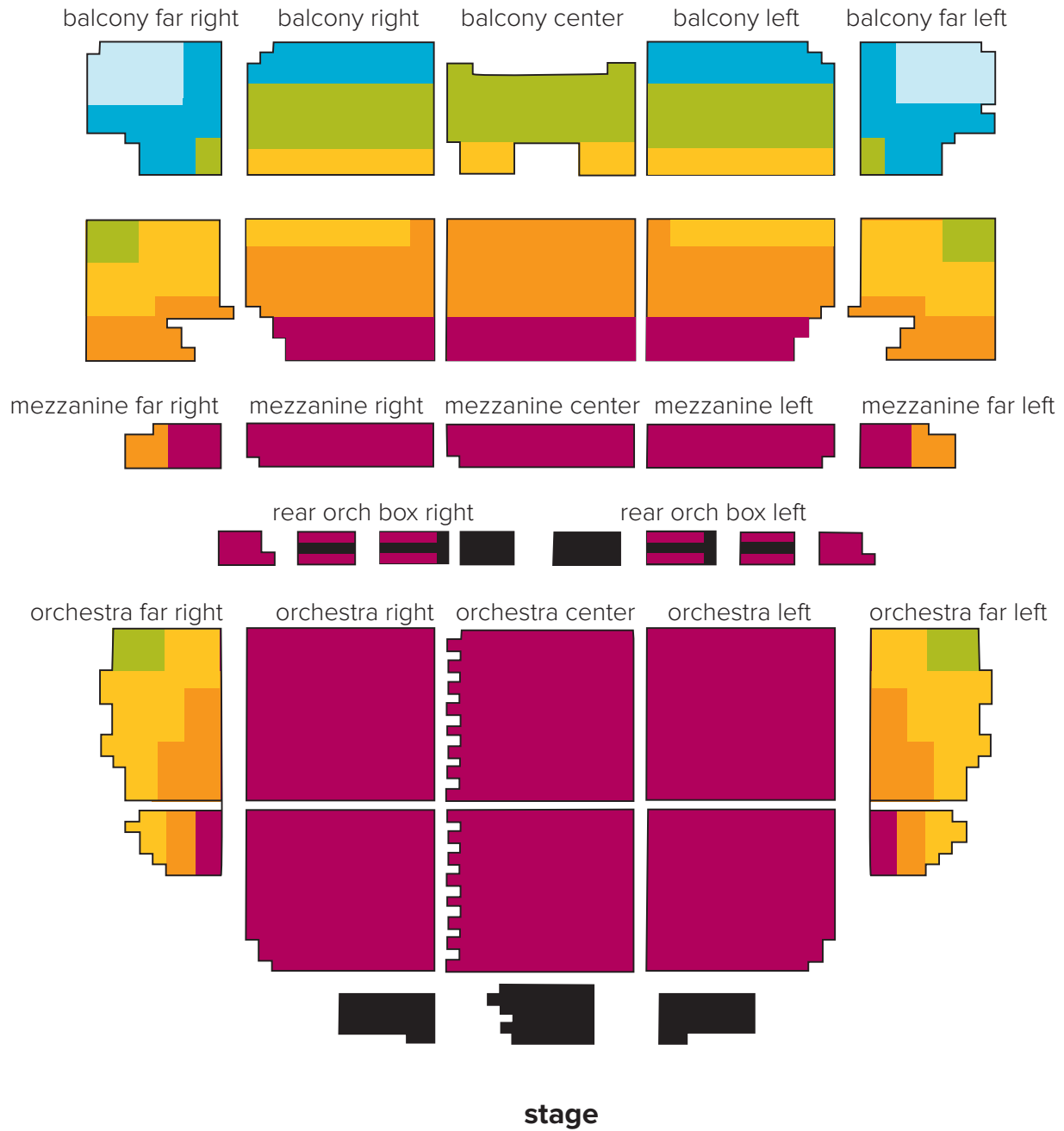

Key

- PRICE 1
- PRICE 2
- PRICE 3
- PRICE 4
- PRICE 5
- PRICE 6
- PRICE 7
- PRICE 8

Boch Center Shubert Theatre

265 Tremont Street

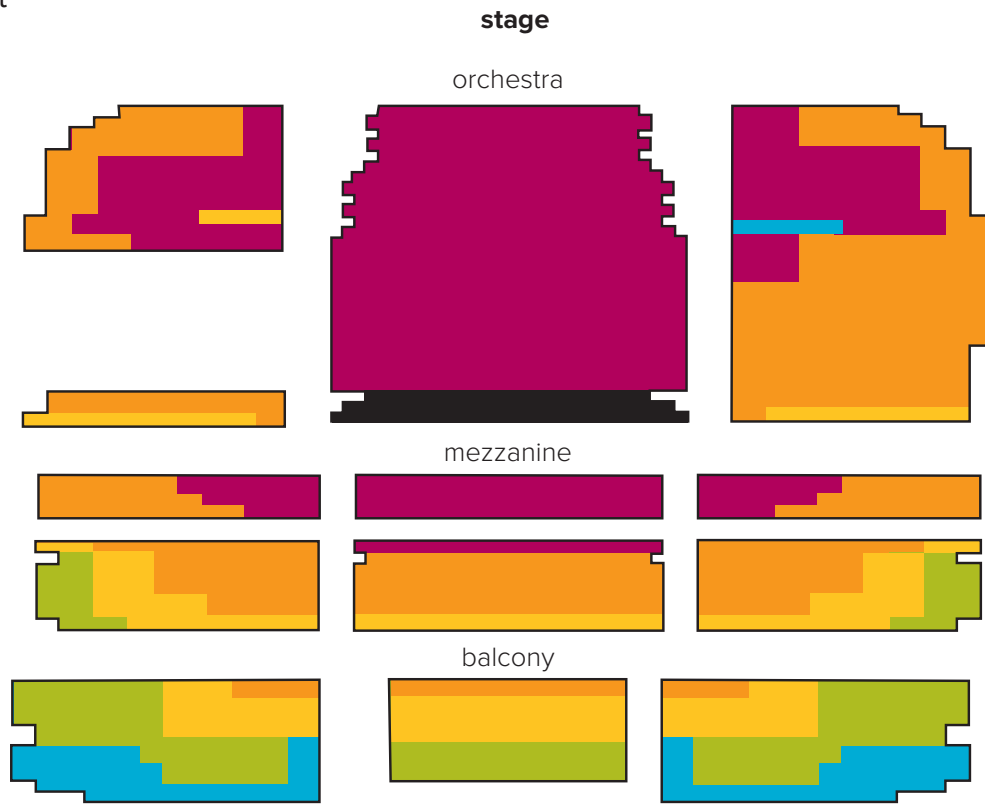

Emerson Paramount Center

559 Washington Street, Boston

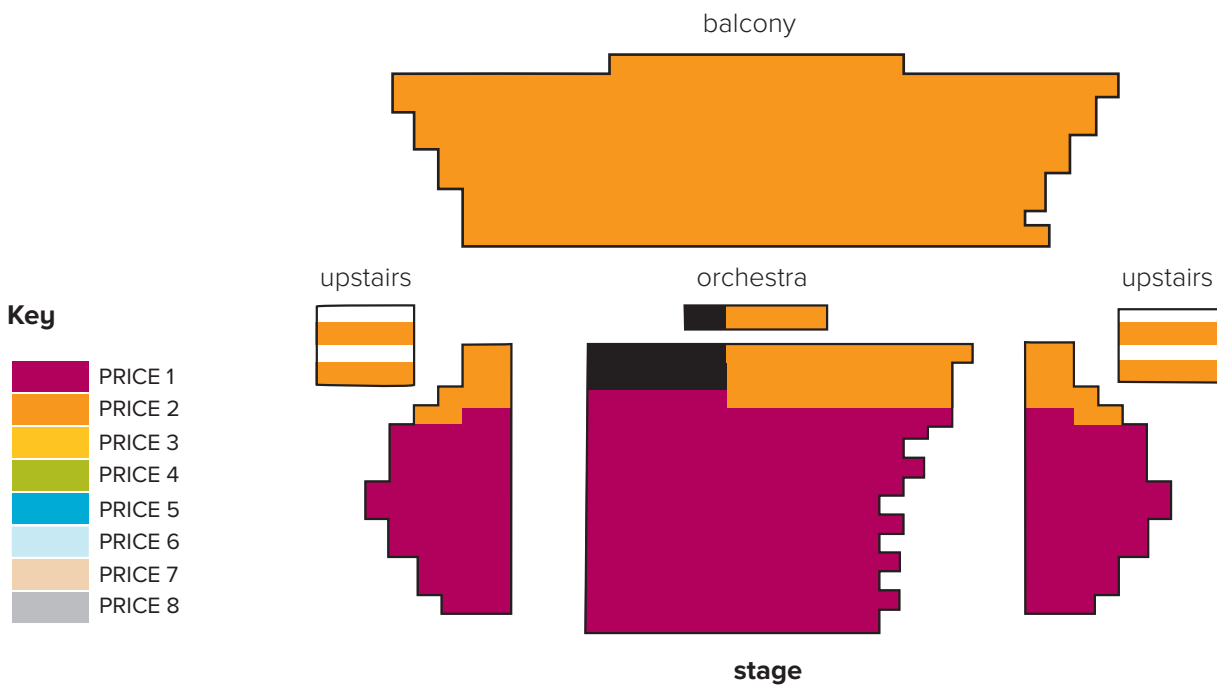

Seating sections may vary by performance.